

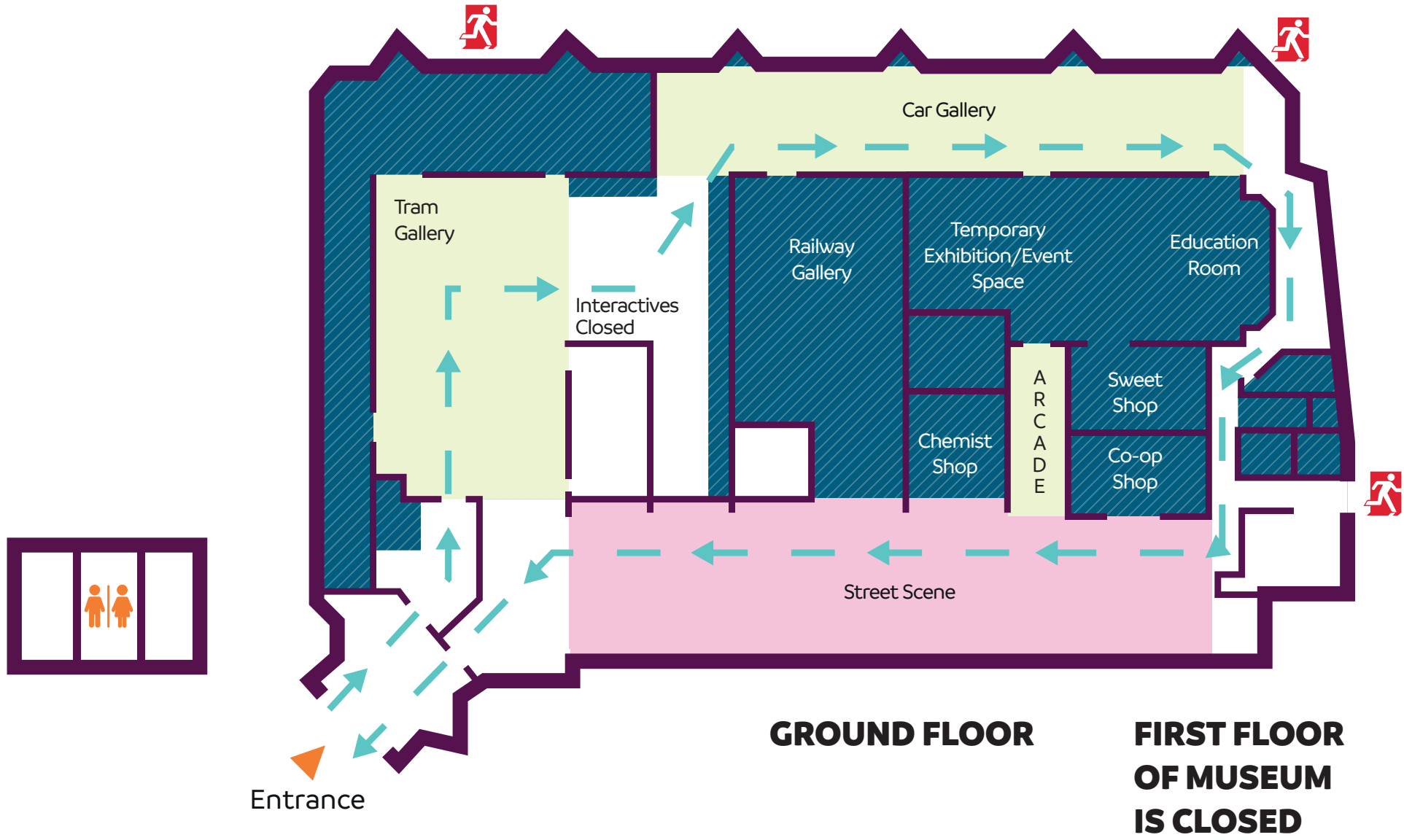

# ONE-WAY MUSEUM ROUTE

## STREETLIFE MUSEUM



 No access to these areas

 One-way route to follow

 Fire Exit

 Toilets



# WELCOME BACK

## A new experience

We are the same experience but with added social distancing, one-way routes and a contactless experience.

For your safety and the safety of other visitors, parts of the museum are currently closed to the public; this includes any interactive or handling elements.

We apologise for any disappointment this may cause but we are sure you will appreciate that we must put the safety of our visitors and staff first. We hope to be able to re-open these areas once it is safe to do so.

## Toilets

Please note toilets and baby changing facilities are currently limited across the museum. The toilets available at the museum are in the garden, these can be accessed from the front desk and can be found marked on the map.

## Cleaning

The frequency of our cleaning throughout the museum has been increased, including toilets and other facilities. Sites will be cleaned thoroughly before opening and at regular intervals during the day. Toilets will be cleaned hourly. We have tried to minimise the need to touch surfaces, however where this is not possible please follow any guidance and signage. In the event of an emergency please follow the guidance given by our staff.

## To ensure a safe visit for everyone please...

- Use the one way system
- Follow any signage placed around the site
- Act on any guidance our staff may give
- Respect social distancing during your visit
- Use the hand sanitiser located at the entrance and at regular intervals throughout the museum
- Limit the items you bring to the museum and keep your belongings with you at all times
- Stay safe

Hull  
Museums



Working in partnership